



DIN RAIL FUSE HOLDER

ZKD SERIES

All the patents are held accountable counterfeiting.

Features

- Ø10 fuse specialized for rail-mounted fuse holder
- Suitable for Ø10.3x38mm fuse
- Can be installed on din rail



DIMENSIONS: 78.2(H)*78(D)*18.2(W)mm

WEIGHTS: 100g

General specifications

MODEL	Pole Number	Rated Voltage	Rated Current
16-ZKD35-1	1		
16-ZKD35-2	2	500 VAC/VDC	32A
16-ZKD35-3	3		

Mechanical details

1 pole



2 poles



3 poles

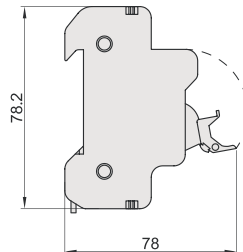

NOTE

1. Reign Power reserve the right to change specifications at any time without notice.